

Boeing CST-100 Starliner  
Item No. MMS 173

It is highly recommended that you visit [www.metal-earth.com/help/mms173](http://www.metal-earth.com/help/mms173) to see the completed model before assembling your own

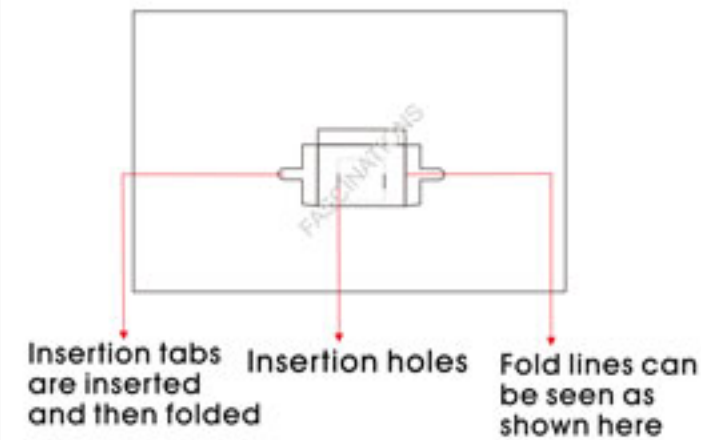

**Legends:**

- E** Engraved side /Color side
- NE** Non-engraved side /Silver side
- Attention point
- Insert tab and bend 90 degrees
- Insert tab and twist 90 degrees

**Assembly tip:**

If needed, slightly twist tabs to hold parts together then untwist and bend them down for a nice finish

**Recommended tools:**

-Wire cutters: helpful for taking parts from the metal sheets.



-Tweezers or needle nose pliers: helpful for folding parts, bending and twisting tabs.



Parts that are in the same color are duplicates

**Metal sheet**

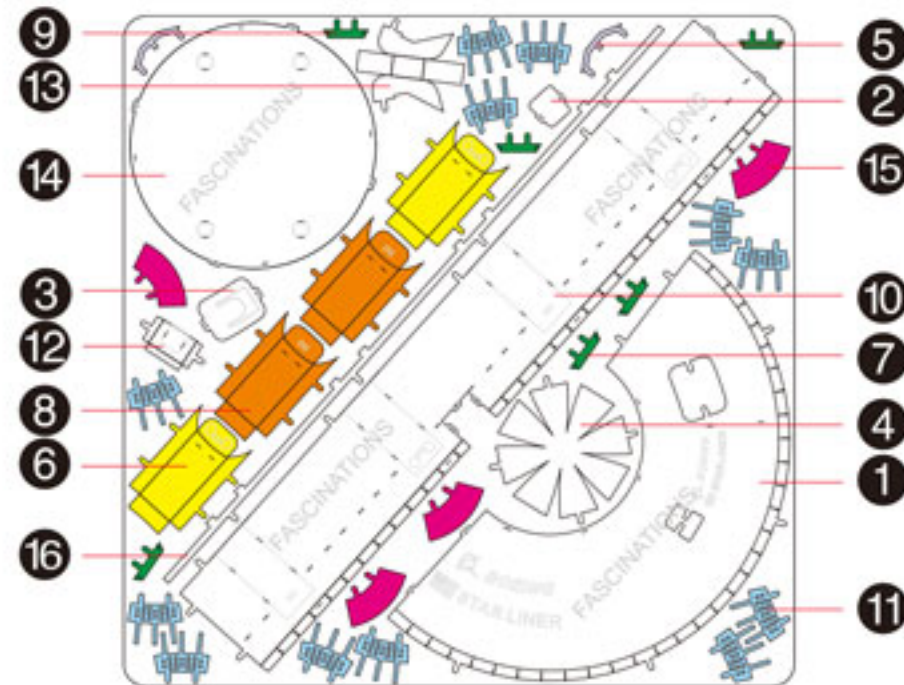

In order to avoid possible injury from sharp edges, please carefully discard the metal sheet after parts have been removed

## Assembly Flow Chart

